

NPG200-12 (12V200Ah)

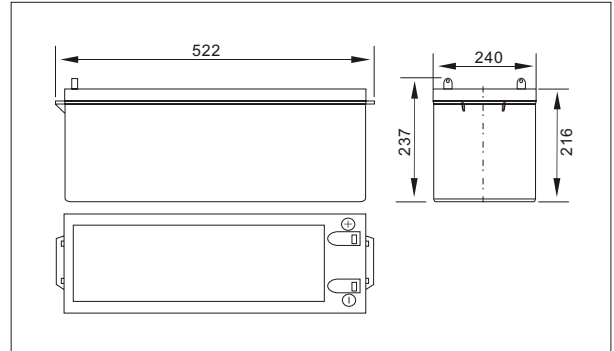

Koyosonic Electronics Co., Ltd

● **Outer dimensions (mm)**



● **Specifications**

Nominal Voltage		12V
Rated capacity (10 hour rate)		200Ah
Dimensions	Total Height	237mm (9.29 inches)
	Height	216mm (8.50 inches)
	Length	522mm (20.6 inches)
	Width	240mm (9.45 inches)
Weight Approx		60Kg (131lbs)

● **Terminal Type (mm)**

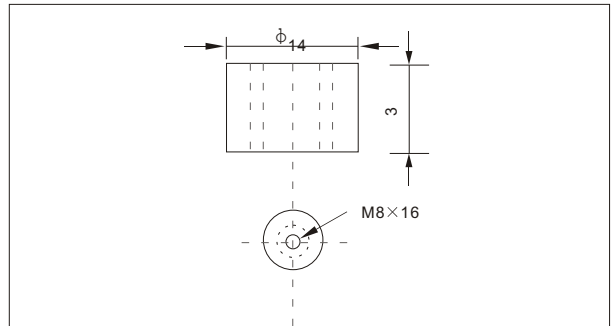

● **Characteristics**

Capacity 25°C (77°F)	20 hour rate (10.5 A)	210AH
	10 hour rate (20 A)	200AH
	5 hour rate (34 A)	170AH
	3 hour rate (50 A)	150AH
	1 hour rate (110 A)	110AH
Internal Resistance	Full charged Battery at 25°C (77°F)	1 mΩ
Capacity affected by Temperature (10hour rate)	40°C (104°F)	102%
	25°C (77°F)	100%
	0°C (32°F)	85%
	-15°C (5°F)	65%
Self-Discharge at 25°C (77°F)	Capacity after 3 month storage	91%
	Capacity after 6 month storage	82%
	Capacity after 12 month storage	64%
Terminal		T11, T19
Charge (constant Voltage)	Cycle	Initial Charging Current less than 60A Voltage 14.5-14.9V
	Float	Voltage 13.6-13.8V

● **Discharge Curves 25°C (77°F)**

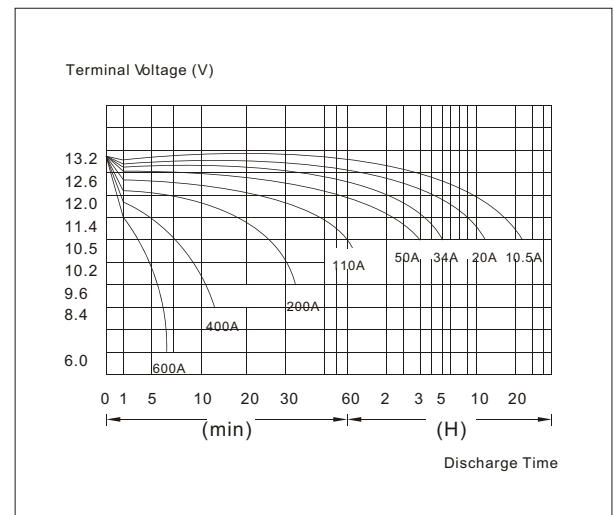

Time	5min	10min	15min	30min	1h	2h	3h	4h	5h	8h	10h	20h
9.6V	A	740	540	380	230	120	70	51.4	40.0	33.0	23.3	11.34
	W	7858	5735	4036	2443	1390	811	595	463	382	269	131.3
10.2V	A	652	492	340	218.0	112.8	66.8	50.0	39.0	32.4	22.8	11.06
	W	7237	5461	3774	2420	1306	774	579	452	375	264	128.1
10.5V	A	628	468	320	212	109	65.2	48.8	38.4	32.0	22.6	10.92
	W	7122	5307	3628	2404	1265	755	565	445	371	262	126.5
10.8V	A	604	444	300	206	106	63.6	47.6	37.8	31.2	22.0	10.80
	W	7031	5168	3492	2398	1229	740	554	435	363	256	125.7
11.1V	A	580	420	280	200	102	62.0	46.0	36.7	30.4	21.4	10.26
	W	6902	4998	3332	2380	1214	738	547	433	362	255	122.1

Gel Technology

Discharge Characteristics

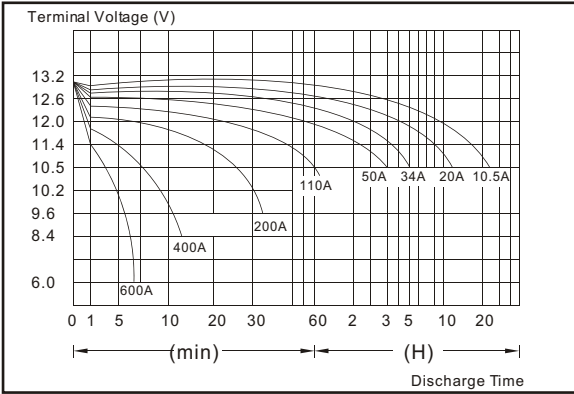

Constant Voltage Charging Characteristics (0.25CA 25 °C)

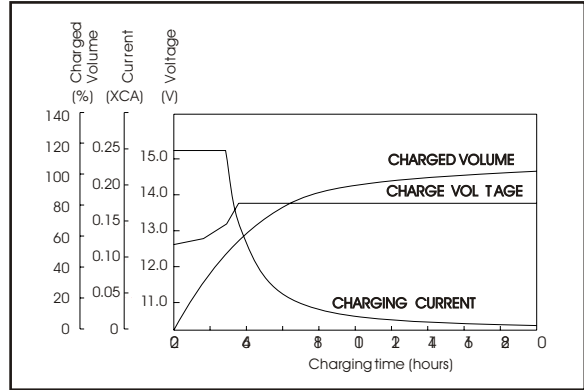

Relationship between Charging voltage and Temperature

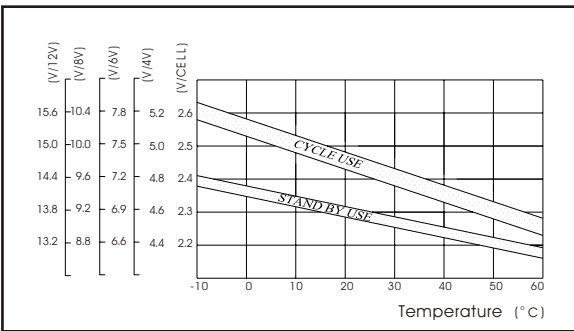

Self-discharge Characteristics

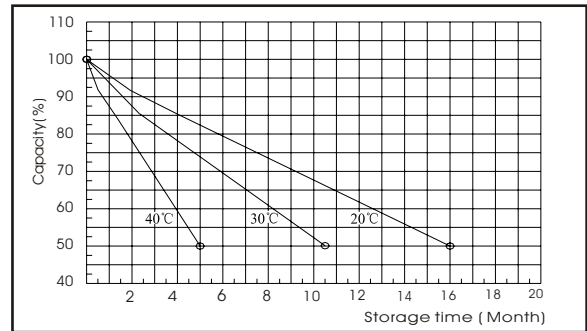

Float service life

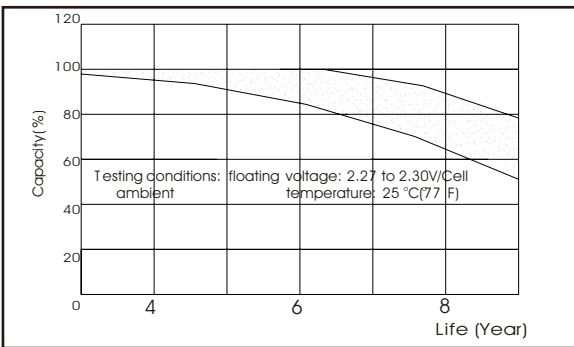

Cycle service life @ different DOD

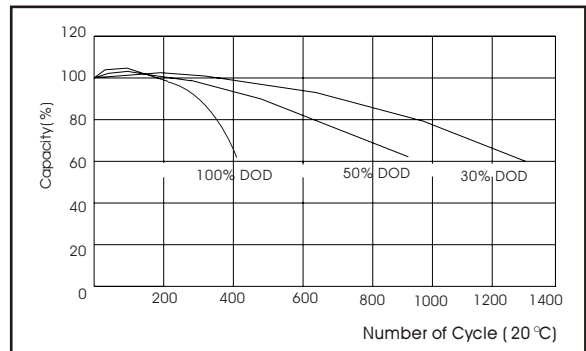

Temperature Effects on Float Life

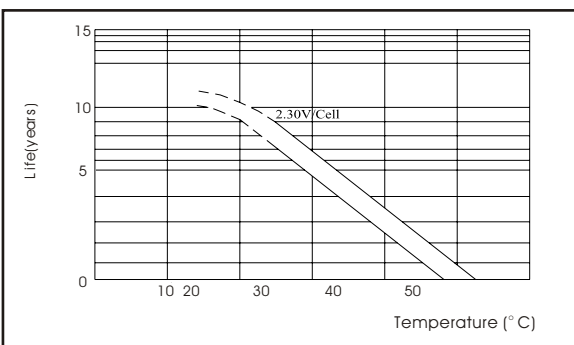

Temperature Effects on Capacity

